

DECOR METAL MOULDINGS

Available as Length and Chop

Metal Profile #2

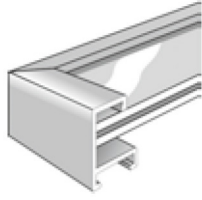
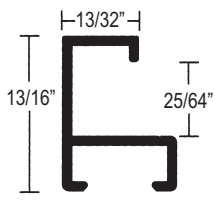

Style #	Finish
2-CG	Contrast Grey
2-FG	Frosted Gold
2-FS	Frosted Silver
2-MBL	Matte Black
2-S	Silver
2-SBL	Shiny Black

Metal Profile #5

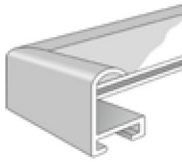
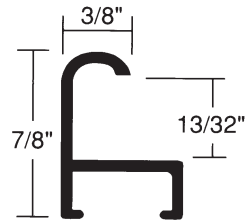

Style #	Finish
5-G	Gold
5-GS	German Silver
5-MBL	Matte Black
5-S	Silver
5-SBL	Shiny Black

Metal Profile #11

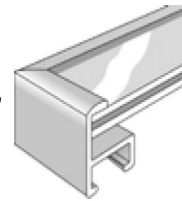
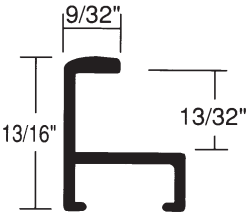

Style #	Finish
11-CG	Contrast Grey
11-FG	Frosted Gold
11-FS	Frosted Silver
11-G	Gold
11-GS	German Silver
11-MBL	Matte Black
11-P	Pewter
11-S	Silver
11-SBL	Shiny Black

Metal Profile #15

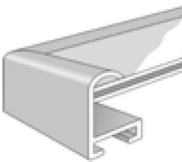
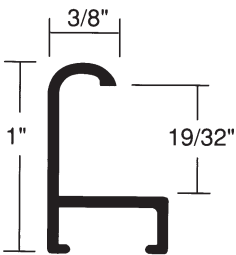

Style #	Finish
15-CG	Contrast Grey
15-FG	Frosted Gold
15-FS	Frosted Silver
15-G	Gold
15-GS	German Silver
15-MBL	Matte Black
15-S	Silver
15-SBL	Shiny Black

Metal Profile #31

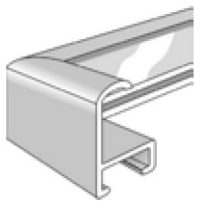
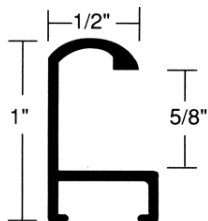

Style #	Finish
31-G	Gold
31-S	Silver
31-SBL	Shiny Black

DECOR METAL MOULDINGS

Style No.	Width inches	Rabbet Height inches	100' Mixed	Length Cost Per Ft.	Chop Cost Per Ft.	Join Cost Per Ft.	Box Price	Appx. Box Qty.	Mldg. Pg. No.
2CG	13/32	25/64						400	193
2FG	13/32	25/64						400	193
2FS	13/32	25/64						400	193
2MBL	13/32	25/64						400	193
2S	13/32	25/64						400	193
2SBL	13/32	25/64						400	193
5G	3/8	13/32						400	193
5GS	3/8	13/32						400	193
5MBL	3/8	13/32						400	193
5S	3/8	13/32						400	193
5SBL	3/8	13/32						400	193
11CG	9/32	13/32						400	193
11FG	9/32	13/32						400	193
11FS	9/32	13/32						400	193
11G	9/32	13/32						400	193
11GS	9/32	13/32						400	193
11MBL	9/32	13/32						400	193
11P	9/32	13/32						400	193
11S	9/32	13/32						400	193
11SBL	9/32	13/32						400	193
15CG	3/8	19/32						320	193
15FG	3/8	19/32						320	193
15FS	3/8	19/32						320	193
15G	3/8	19/32						320	193
15GS	3/8	19/32						320	193
15MBL	3/8	19/32						320	193
15S	3/8	19/32						320	193
15SBL	3/8	19/32						320	193
31G	1/2	5/8						320	193
31S	1/2	5/8						320	193
31SBL	1/2	5/8						320	193

METAL FRAME HARDWARE



Item	Quantity	Price	Item	Quantity	Price
Screw-in Hanger					
399 <input checked="" type="checkbox"/>	100/box		399T	1000/box	
Zinc Plated Tapped Corner Angle w/Set Screws inserted					
400 <input checked="" type="checkbox"/>	200/box		400T	1000/box	
Back Plate Angle to be used w/#400 (#400T)					
401 <input checked="" type="checkbox"/>	200/box		401T	1000/box	
3/8" Spring Clip-center notched					
402 <input checked="" type="checkbox"/>	200/box		402T	1000/box	
European Hanger w/Set Screw					
403 <input checked="" type="checkbox"/>	200/box		403T	1000/box	
Snap in Hanger after Frame is Assembled					
404 <input checked="" type="checkbox"/>	200/box		404T	1000/box	

Enough Hardware for 1 Frame

Item #1-SCREW		Item #1-SNAP	
Includes:		Includes:	
Item #	Qty	Item #	Qty
#400	4 Pcs.	#400	4 Pcs.
#401	4 Pcs.	#401	4 Pcs.
#402	8 Pcs.	#402	8 Pcs.
#403	2 Pcs.	#404	2 Pcs.
Bumpers	4 Pcs.	Bumpers	4 Pcs.

Enough Hardware for 100 Frames

Item #100-SCREW		Item #100-SNAP	
Includes:		Includes:	
Item #	Qty	Item #	Qty
#400	400 Pcs.	#400	400 Pcs.
#401	400 Pcs.	#401	400 Pcs.
#402	800 Pcs.	#402	800 Pcs.
#403	200 Pcs.	#404	200 Pcs.
Bumpers	400 Pcs.	Bumpers	400 Pcs.

Item #	1 @	10 + @
1-SCREW <input checked="" type="checkbox"/>		
1-SNAP <input checked="" type="checkbox"/>		

Item #	1 @	2 + @	5 + @
100-SCREW			
100-SNAP			